

# Morgan Valley-Twinkle (Linn County) 345 kV Transmission Line Project

## PROJECT OVERVIEW

ITC Midwest (ITC) is planning to build a new 345 kV (345,000 volt) electric transmission line that travels through eastern Marshall, Tama, Benton and southwestern Linn counties from ITC Midwest's planned Twinkle substation on the east side of Marshalltown to the Morgan Valley Substation near Fairfax.

In Linn County, the line enters from Benton County and travels a short distance easterly, then south, and then back easterly into the Morgan Valley Substation southeast of Fairfax.

The proposed line segment in Linn County is about 3.5 miles long, with the entire project in the four counties approximately 61.5 miles in length. Approximately 2.5 miles of this line will be built and double circuited (two circuits on each structure) with an existing 345 kV line, and when construction is complete the current standalone 345 kV line will be removed. The final route may change and will be determined when easement negotiations with landowners are completed and the Iowa Utilities Board has approved the project. (Please see map of the proposed line route corridor in Linn County on the back.)

### ***Why is this line needed?***

Responding to the needs of the changing energy landscape, the Midcontinent Independent System Operator – MISO – the grid planning organization for our region, has devoted several years of intensive, collaborative effort to develop a Long-Range Transmission Plan – known as LRTP – to build needed high-voltage transmission infrastructure across the region. ITC Midwest was actively involved with this process and advocated for the LRTP projects. One segment of the LRTP portfolio is the proposed Morgan Valley-Twinkle project.

### **The Morgan Valley-Twinkle project will provide numerous benefits and drive value for electric consumers locally and regionally. When completed, this transmission line will:**

- Increase transmission infrastructure to **improve system reliability**
- Enhance grid resilience to better **withstand extreme weather**
- **Expand access to generation resources** for electric consumers by reducing transmission system congestion
- Improve distribution of **lower-cost energy resources**, including renewables

### ***Whose approval is required to build this line?***

The Iowa Utilities Board grants regulatory approvals, called franchises, to Iowa utilities seeking to build transmission lines in the state. As part of its review process, the IUB reviews many aspects of the project such as the need for the line and the proposed route. The IUB has very clear criteria and a clear process for utilities to follow to request a franchise.

### ***What is being done to ensure this line will be safe?***

This line will be designed to meet and even exceed the National Electrical Safety Code (NESC), the nationally-recognized design standard in the United States, as well as the Iowa Electrical Safety Code. Among other things, these codes require construction to meet clearance requirements and withstand extreme weather conditions. As the line owner, ITC Midwest will make sure that the line is clear of trees and other vegetation.

# Morgan Valley-Twinkle (Linn County) 345 kV Transmission Line Project

## What is ITC Midwest doing to minimize impact on landowners and current land uses?

ITC Midwest seeks to minimize the impact of the line on existing land uses. The company is committed to protecting the environment and will fully compensate landowners for any damages that occur during the construction process. Where possible, this new line will be double-circuited with existing transmission lines to mitigate the need for a new transmission corridor across privately owned land. To minimize the footprint of the line, ITC Midwest plans to use steel monopoles.

## How will ITC Midwest work with landowners?

Under Iowa law, ITC Midwest cannot negotiate for easements until after the Iowa Utilities Board holds a public information meeting. For this project, the Linn County meeting was held in Fairfax on May 18, 2023. In the coming months, ITC Midwest representatives will begin meeting with affected landowners in the proposed corridor to explain the process and their rights, and ultimately, to begin negotiations to secure voluntary easements. Landowners are compensated for permitting ITC Midwest to secure an easement on their property. ITC Midwest understands and appreciates the impact that new line construction has on landowners and pledges to treat *all* landowners with the utmost respect during this important process.

## Morgan Valley-Twinkle project proposed line corridor route in Linn County

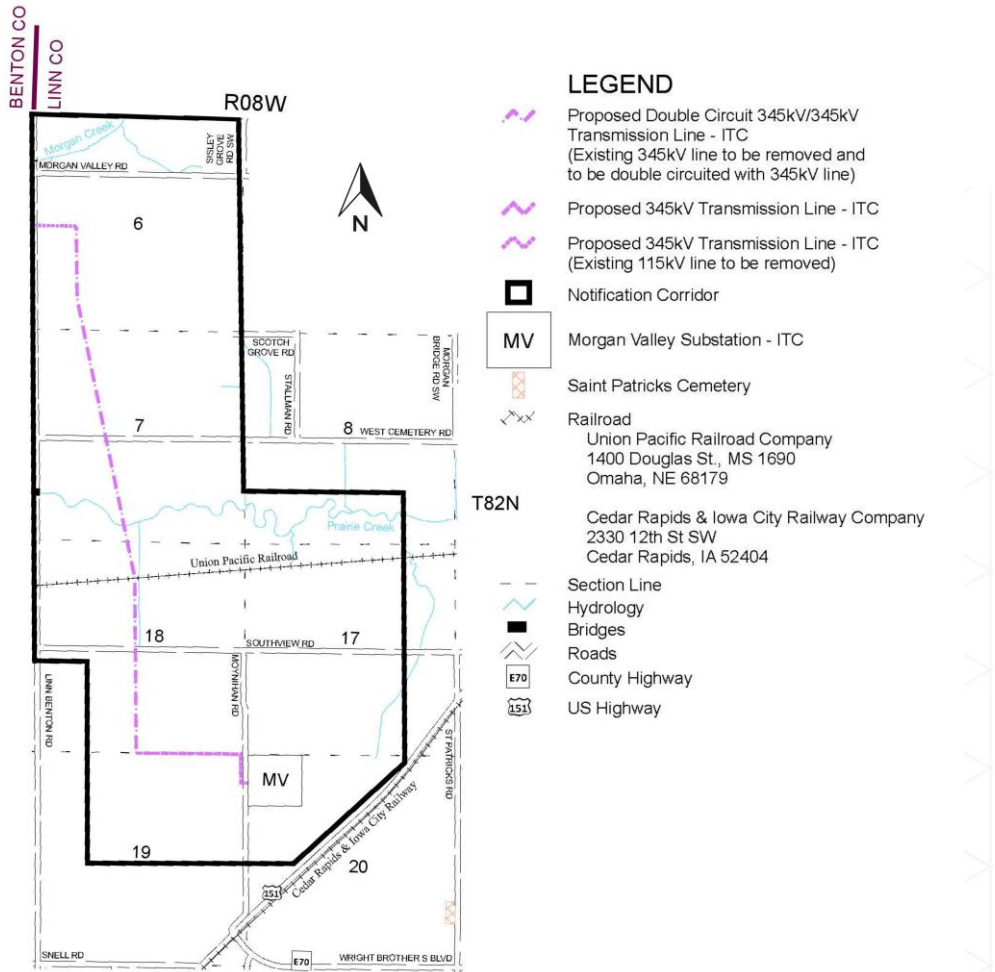

## Project Contacts

If you have questions, you can contact ITC using our toll-free customer line at 1-877-482-4829. Once construction begins, Shawn Mathis and Ian Buschbom will be ITC Midwest’s project leads.



**Shawn Mathis**  
Project Manager  
(319) 899-2163  
[smathis@itctransco.com](mailto:smathis@itctransco.com)



**Ian Buschbom**  
Field Supervisor  
(641) 750-6924  
[ibuschbom@itctransco.com](mailto:ibuschbom@itctransco.com)